

LEGEND

- Application site boundary
- Indicative stage boundary

Anticipated Population (2.8 people per dwelling) - 294

The number of lots, areas, dimensions and stage boundaries may vary in plans of subdivision to be certified, based on final survey work associated with each subdivision stage.

Location and detailed design of easements, road pavements, indented car parking bays, crossovers and footpaths are provided in the relevant Plans of Subdivision and Engineering Plans submitted for certification or approval. Any such design details shown on the Subdivision Plan are indicative only.

Detailed design of landscape works is provided in the relevant Landscape Plans.

This plan is subject to Knox City Council approval.

Note: This subdivision plan was prepared using a CAD survey base plan provided by Paroissien Grant and Associates Pty Ltd and reflects an overall site masterplan prepared by Architectus.

Client

DEVELOPMENT VICTORIA

Project

621 BURWOOD HIGHWAY KNOXFIELD

Drawing Title

SUBDIVISION PLAN

Project Number

08340-002
Sheet 1 of 2

Drawing Number

V002

© Collie Town Planners Pty Ltd

Issue Date

20042022

Scale 1:3000 (A3)

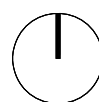

COLLIE TOWN PLANNERS PTY LTD
ABN 11 052 264 687



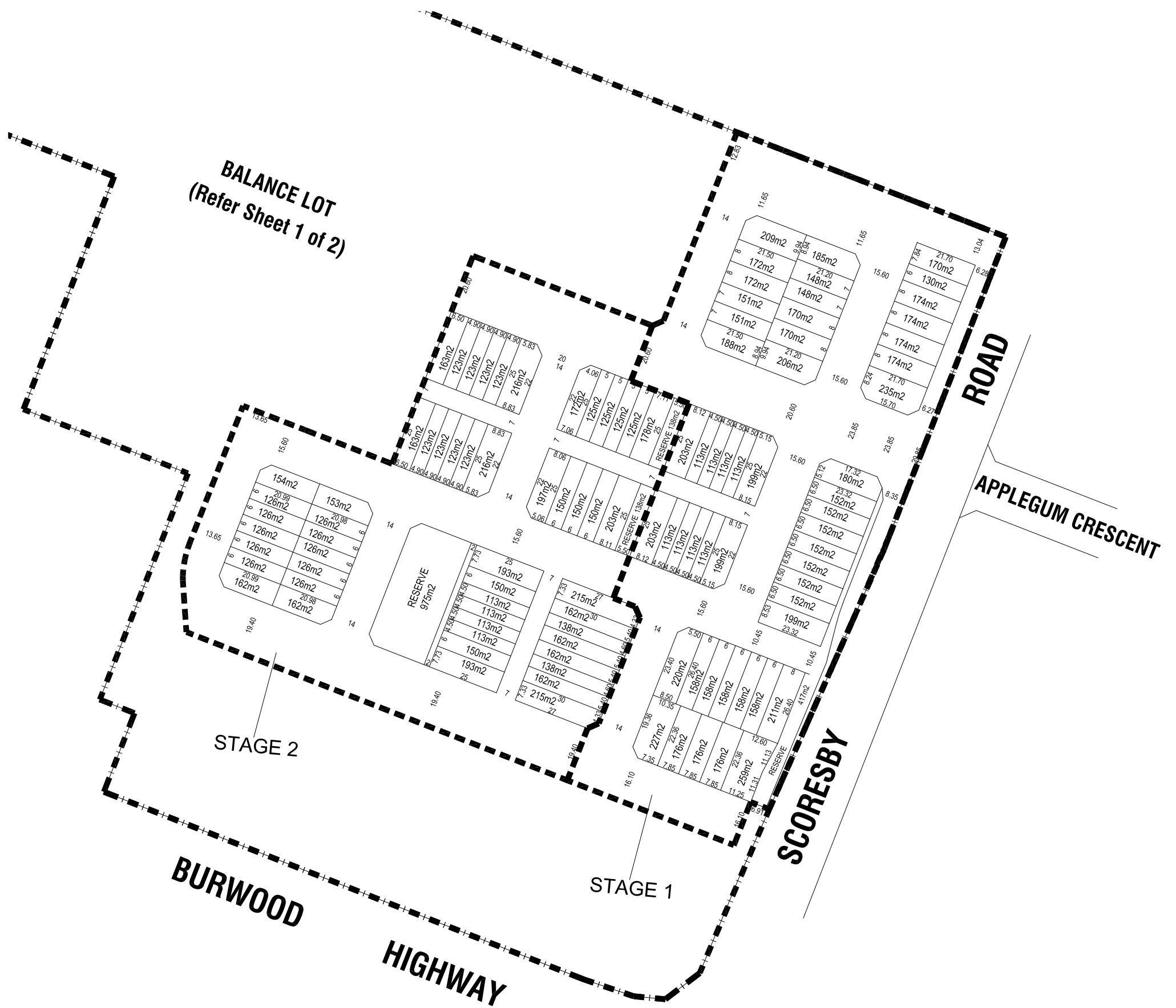

LEGEND

- ▬▬▬▬ Application site boundary
- ▬▬▬▬ Indicative stage boundary

Anticipated Population (2.8 people per dwelling) - 294

The number of lots, areas, dimensions and stage boundaries may vary in plans of subdivision to be certified, based on final survey work associated with each subdivision stage.

Location and detailed design of easements, road pavements, indented car parking bays, crossovers and footpaths are provided in the relevant Plans of Subdivision and Engineering Plans submitted for certification or approval. Any such design details shown on the Subdivision Plan are indicative only.

Detailed design of landscape works is provided in the relevant Landscape Plans.

This plan is subject to Knox City Council approval.

Lot Dimensions (metres)	Area (m ²)	No. of Lots	% of Total
4.5 x 25	113	20	19
4.5 x 30	135	2	2
5 x 25	125	4	3
5 x 30	150	4	3
6 x 21	126	10	10
6 x 21.5	130	1	1
6 x 23.3	140	8	8
6 x 25	150	7	7
6 x 26.6	160	5	5
7 x 21	147	6	6
7 x 21.5	150	3	3
7 x 22.3	156	4	3
7 x 25	175	4	3
7 x 30	210	2	2
8 x 21	168	3	3
8 x 21.5	172	8	8
8 x 23.3	186	1	1
8 x 25	200	8	8
8 x 26	208	2	2
9 x 21	189	1	1
9 x 21.5	193	1	1
11 x 22.3	245	1	1
Total		105	100

Note: This subdivision plan was prepared using a CAD survey base plan provided by Paroissien Grant and Associates Pty Ltd and reflects an overall site masterplan prepared by Architectus.

Client

DEVELOPMENT VICTORIA

Project

621 BURWOOD HIGHWAY KNOXFIELD

Drawing Title

SUBDIVISION PLAN

Project Number

**08340-002
Sheet 2 of 2**

Drawing Number

V002

© Collie Town Planners Pty Ltd

Issue Date

20042022

Scale 1:1500 (A3)

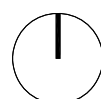

COLLIE TOWN PLANNERS PTY LTD
184 1100 29467